

## What does CC mean in CF optical module



### Overview

OD: right eye OS: left eye OU: both eyes CC: with correction SC: without correction BCVA: best-corrected visual acuity NVA: near visual acuity PH: pinhole. OD: right eye OS: left eye OU: both eyes CC: with correction SC: without correction BCVA: best-corrected visual acuity NVA: near visual acuity PH: pinhole. My name is Dr. I am an Optometrist at the Tayani Institute. Feel free to come back anytime for more ocular health information. used to describe a patient's ability to see only light. Distribution or use of material in whole or in part outside of the CCOA® Program is ion of Optometrists. For example, if the patient's visual acuity is 20/100 then the smallest line they correctly read at 20 feet could be read by a person with normal vision at 100 feet. The Snellen chart - consisting. Technical reference information on common optical system symbols and abbreviations.

## What does CC mean in CF optical module

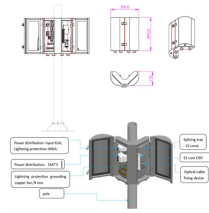

Technical reference information on common optical system symbols and abbreviations.



Overloading of optical power, also known as saturated optical power, refers to the maximum allowable optical power that the optical module can withstand without causing signal ...

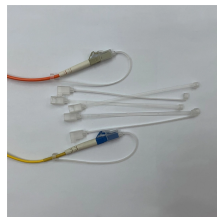





Indicates that a vision measurement was made with the patient not wearing eyeglasses or contact lenses. Study with Quizlet and memorize flashcards containing terms like cc, CF, CL and more.



Visual acuity with eye chart at Distant 20 feet (6 m) and with (cc: Latin cum correctore) correctors (spectacles); Dsc is without (sc: Latin sine correctore) correctors. See Visual\_acuity#Legal\_definitions.

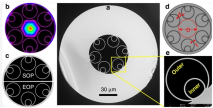

A comprehensive list of common eye report abbreviations for ophthalmologists and vision care professionals. Quick reference guide.

	<p>Customization - The act of tailoring the optical characteristics of a progressive lens design to the individual wearer based upon information specific to that wearer.</p>
	<p>q.2h.</p>
	<p>ion of Optometrists. Distribution or use of material in whole or in part outside of the CCOA® Program is.</p>
	<p>Feel free to come back anytime for more ocular health information. OD: right eye OS: left eye OU: both eyes CC: with correction SC: without correction BCVA: best-corrected visual acuity NVA: near visual ...</p>
	<p>The optics module uses COB technology to mount photodiodes directly to the circuit board. The COB technology enables the photodiodes to be mounted with high accuracy and the photodiode packages ...</p>

## Contact Us

For more information, pricing, or custom solutions, please contact us:

Website: <https://www.samastersbaseball.co.za>

Email: [sales@samastersbaseball.co.za](mailto:sales@samastersbaseball.co.za)

Phone: +27 63 874 2095

Address: 15 Innovation Drive, Technopark, Stellenbosch, 7600, South Africa

This document is for informational purposes only. Specifications subject to change without notice.

