

Huawei switch optical port not working



Overview

This document describes how to check the switch interface or port status and how to locate an interface physically down fault and restore the interface to the up state. Hardware failures: include hardware. This article summarizes several solutions for using optical modules with switches and common problems encountered during usage, along with specific solutions. Huawei S5720-32P-EI-AC Switch II. Indicates the MIB object ID of the alarm. See the. A: on the premise that the equipment is working properly, we first need to eliminate the problem of the optical fiber line itself, and then check whether the state of the optical aperture is open, whether the optical fiber jumper is connected to the reverse, and whether the mode of the optical. Optical modules are widely used in switches, network interface cards (NICs), routers, and other communication devices. During use, reading optical module information helps understand its real-time operating status, enabling faster troubleshooting of link abnormalities.

Huawei switch optical port not working



Learn how to validate Huawei CloudEngine transceiver compatibility with switch models, DOM support, and fiber types, plus pitfalls, costs, and a decision matrix.



When connecting two devices, check whether optical modules match optical interfaces, whether optical modules match fiber models, and whether optical modules and fibers are connected correctly.

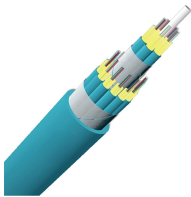

Problem: All optical ports cannot be connected, and the indicator lights are not on. Solution: To solve this problem, you can follow these steps: Check if the fiber and optical modules ...



If this optical module is not delivered from Huawei or is not customized for Huawei, replace it with a Huawei-customized optical module. Cause 2: Temperature of the installed optical ...



HUAWEI S Series Switch-Handle an Optical Interface's Failure to Go Up video provides guidance on how to handle an optical interface's failure to go Up. HUAWEI S Series Switch...



If the problem is not caused by the optical modules, fibers, or intermediate device, connect the switch to another interface or replace the switch to check whether the problem is relevant to the ...

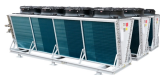

If the transmit power remains low, replace the optical module or install it in another optical port to check whether it is faulty. If the optical module is faulty, send it to Huawei for repair or ...



Receiving power too low (If Current RX Power < Default RX Power Low Threshold): May cause port down or packet loss, check whether distance is too far that is over the limit of the module ...



A: The Optical Port of Hua-san S5120-28P-LI switch is not the type of photoelectricity reuse. First, we need to confirm whether the type of optical fiber jumper and optical transceiver is ...



A: The Optical Port of Hua-san S5120-28P-LI switch is not the type of photoelectricity reuse. First, we need to confirm whether the type of optical fiber ...

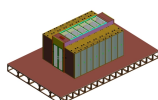

The following uses the Moduletek SFP-10G-LR module connected to a Huawei S6700 switch as an example to introduce how to read information of the connected optical module on a Huawei switch.

Contact Us

For more information, pricing, or custom solutions, please contact us:

Website: <https://www.samastersbaseball.co.za>

Email: sales@samastersbaseball.co.za

Phone: +27 63 874 2095

Address: 15 Innovation Drive, Technopark, Stellenbosch, 7600, South Africa

This document is for informational purposes only. Specifications subject to change without notice.

